

**Kaffee Klar<sup>®</sup>**  
THE AUSTRIAN BRAND

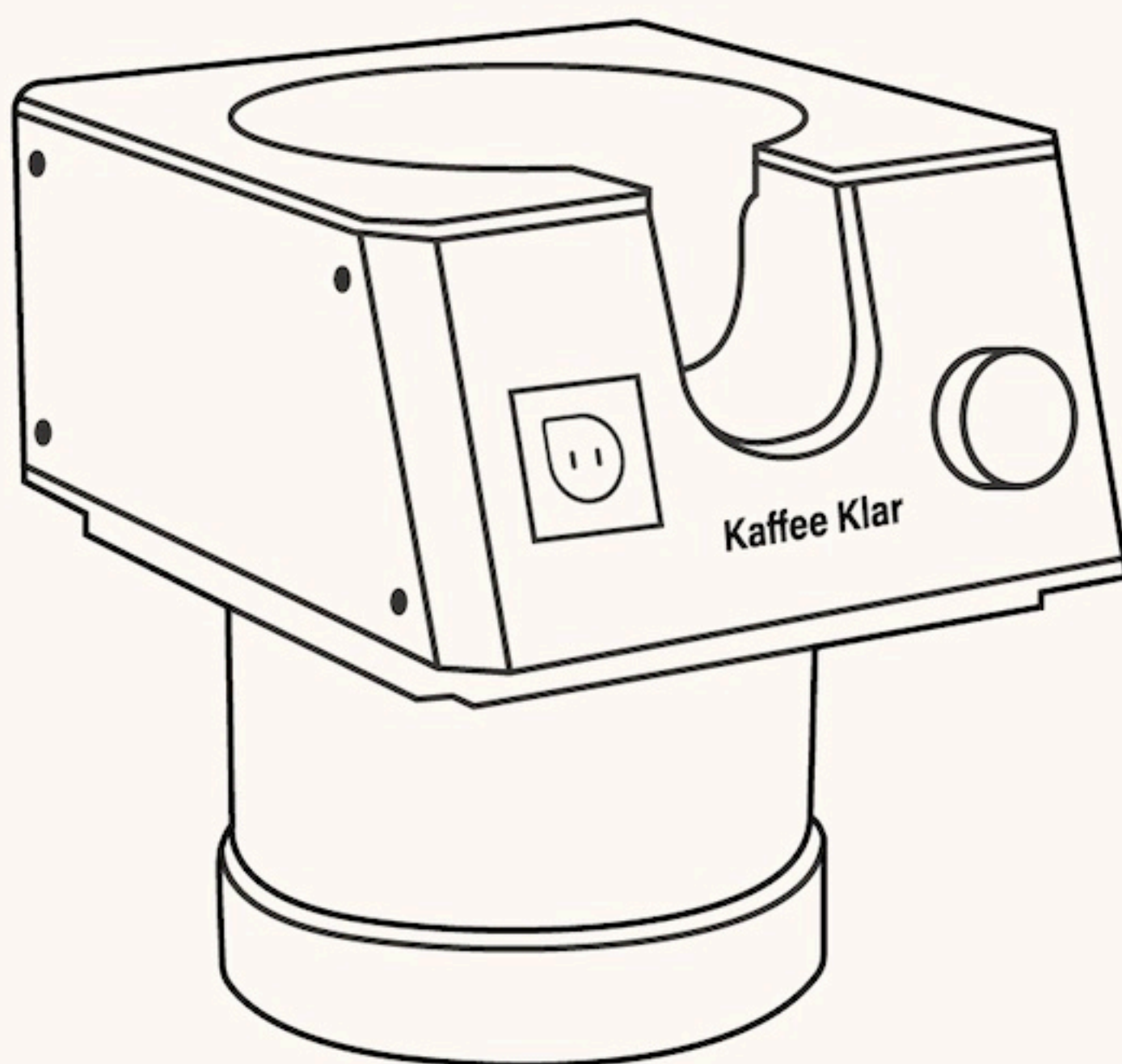

# INSTRUCTION MANUAL

T1 Automatic Portafilter Cleaner



## Portafilter cleaner (embedded) opening auxiliary diagram

(154mm) Product Side

**Kaffee Klar<sup>®</sup>**  
**THE AUSTRIAN BRAND**



[www.kaffee-klar.com](http://www.kaffee-klar.com)  
Product after-sales service

(139mm) Product front



# DIRECTORY



1. Include Items	01
2. T1 Component Introduction	02
3. NAGT Interactive Operating System Description	03
4. Soft Rubber and Filter Shape Matching Diagram Explanation	04
5. NAGT Interactive Operating System Description	05
6. Electrical Parameters And Installation Instructions	06

## T1 Safety and Important Information

1. Use safety	07
2. Usage Scenarios	07
3. Personal Safety	08
4. Operation Briefings	08
5. Use And Precautions	08

Instructions steps



# 01 AUTOMATIC PORTAFILTER CLEANER

## T1 AUTOMATIC PORTAFILTER CLEANER

T1 is an innovative new coffee device designed to help baristas quickly clean portafilters. It significantly improves coffee output efficiency, protects baristas' wrists, optimizes the bar setup, and reduces noise caused by traditional knock-cleaning methods.

Inspired by the sleek aesthetics of metallic finishes, T1 features a stainless steel metal casing, combining functionality with a striking industrial design.

### Main Features

Integrated photoelectric sensor, compatible with various materials and shapes of portafilters, preventing accidental activation. NAGT interactive operating system, built-in Cortex-M4F chip, creating an independent operating environment. Built-in Cortex-M4F chip with FFT (Fast Fourier Transform) algorithm, capable of accurately analyzing physical proximity, detecting, and operating the coffee machine portafilter.

### Include Items

- |                                   |      |
|-----------------------------------|------|
| • T1 main unit                    | * 1  |
| • Vertical installation converter | * 1  |
| • Power adapter                   | * 1  |
| • Cleaning head main body         | * 2  |
| • User manual                     | * 1  |
| • Opening auxiliary diagram       | * 1  |
| • Cleaning soft rubber(Model 02)  | * 1  |
| • Cleaning soft rubber(Model 03)  | * 1  |
| • M2.5*4 Screws                   | * 4  |
| • M2.5*5 Screws                   | * 4  |
| • M3 Screwdriver                  | * 1  |
| • Coffee grounds disposal bag     | * 10 |
| • Brush                           | * 1  |



# 02 AUTOMATIC PORTAFILTER CLEANER

EN

## T1 Component Introduction

Note: The machine does not include a portafilter. This diagram is for usage explanation only.



Insert power cable in the direction of the arrow



Power cable connection completed

# 03 AUTOMATIC PORTAFILTER CLEANER

## Interactive operating system description

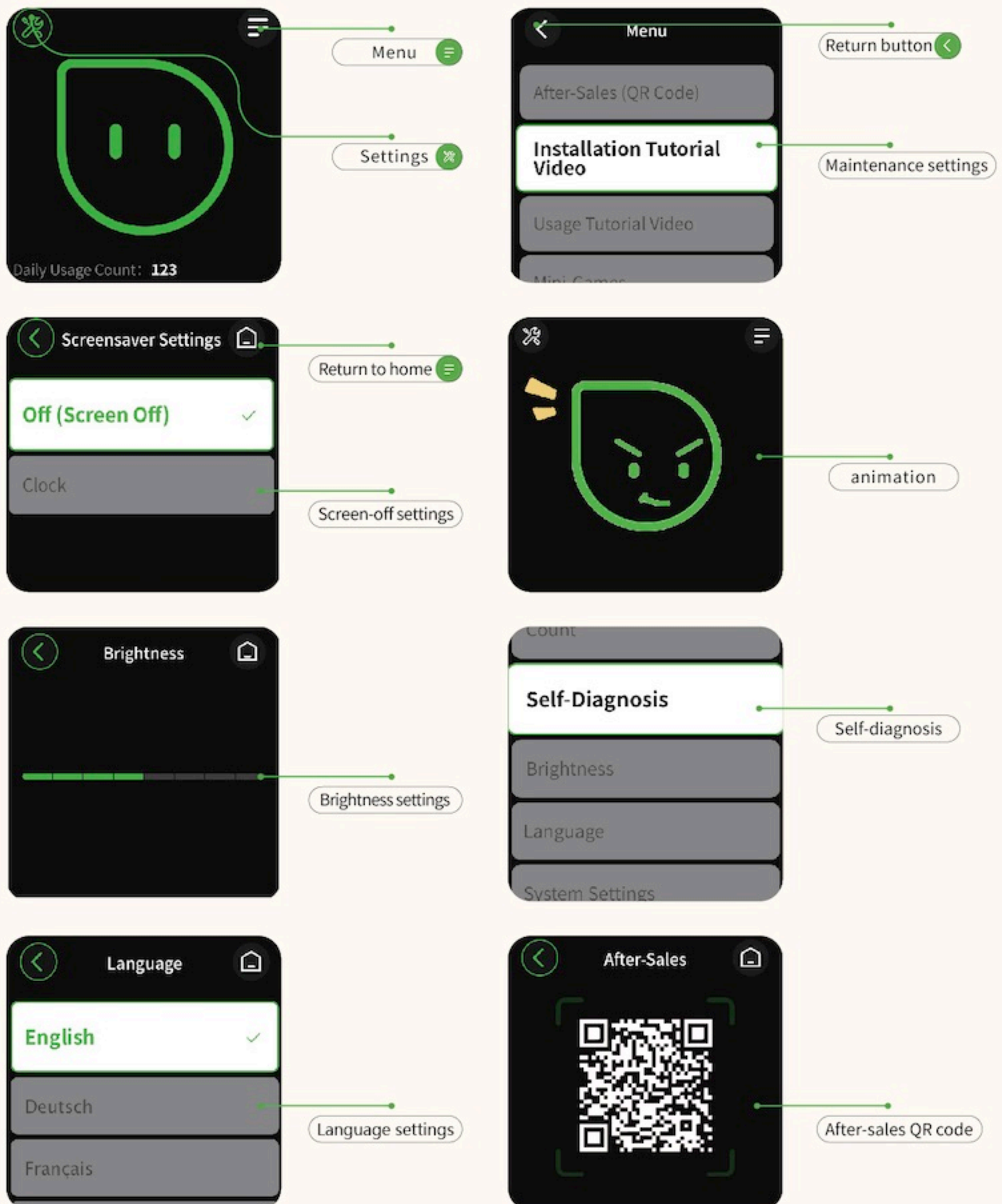



# 04 AUTOMATIC PORTAFILTER CLEANER

EN

## Soft Rubber and Filter Shape Matching Diagram Explanation



(Flat bottom angled soft rubber)

Model:01

《 Flat bottom angled cleaning head



(Arc bottom right-angle soft rubber)

Model:02

《 Arc bottom right-angle cleaning head



(Flat bottom right-angle soft rubber)

Model:03

《 Flat bottom right-angle cleaning head

## Installation Method Diagram



1. Embed the main unit into the countertop with an opening size of 139mm in length and 154mm in width.



2. Place the main unit into the standard bucket.



Not included,  
sold separately.

3. Assemble the main unit with the vertical converter and place it into the vertical bucket.



# 05

## AUTOMATIC PORTAFILTER CLEANER

### Cleaning Head Crossbar Installation Diagram

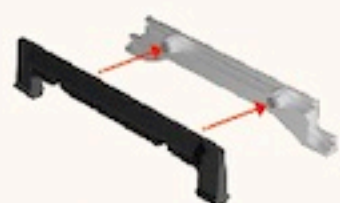

1. Take out the toothed crossbar and crossbar soft rubber.



2. Place the crossbar soft rubber on one side of the toothed crossbar.



3. Take out the non-toothed crossbar.



4. Place the non-toothed crossbar on the other side and merge.

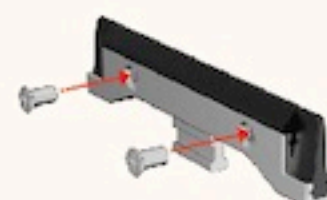

5. Take out the standard M2.5x4 screws.



6. Tighten the screws to complete the crossbar installation.



### Main Body Installation Diagram

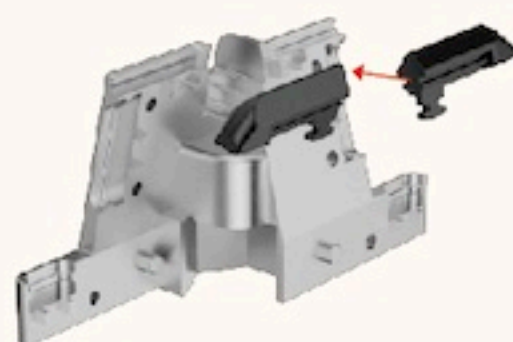

1. Take out the half-body with magnets and two side soft rubbers.

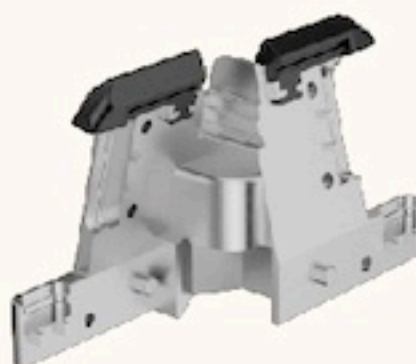

2. Place the side soft rubbers into the slots.



3. Take out the 4-hole and 2-hole brushes.



4. Insert the brushes into the half-body slots.

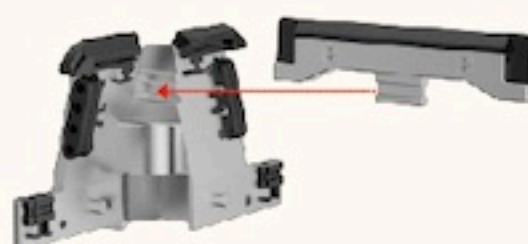

5. Take out the already installed crossbar and half-body.



6. Insert the crossbar into the half-body slot.

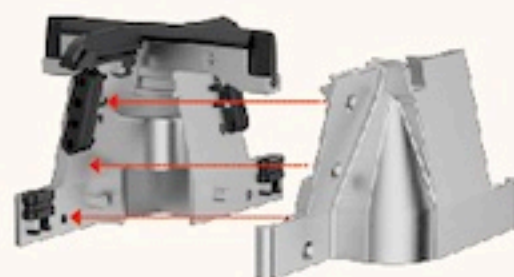

7. Take out the remaining half-body.



8. Align and merge.

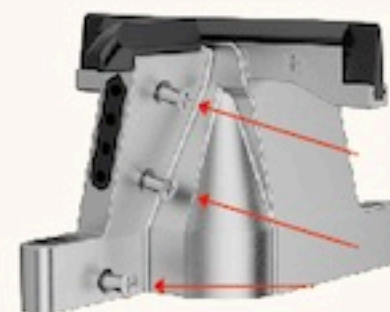

9. Tighten the M2.5x5 screws.

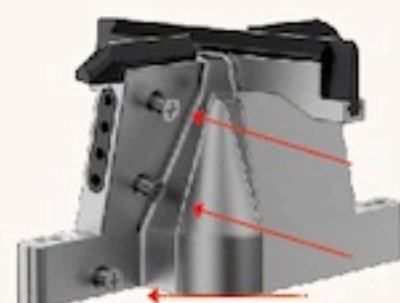

10. Tighten the screws on the opposite side.

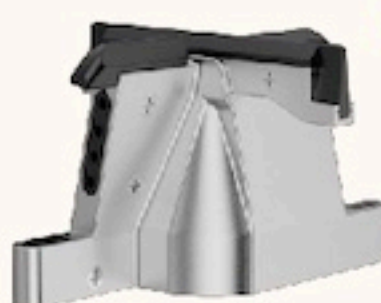

11. Cleaning head assembly completed.





# 06 AUTOMATIC PORTAFILTER CLEANER

EN

## Electrical parameters

- Operating voltage — 24V
- Static current — 107mA
- Operating current — (motor no-load) 238mA
- Display screen — TFT-1.54
- CPU frequency — 200MHz
- LCD refresh rate — 33Hz
- Cortex-M4F CPU core — Cortex-M4F
- Standby current — 13mA
- Input voltage range — 9V-40V
- LED port output — 24V@50mA  
(8 in series, 3 in parallel)
- Motor port output — 24V@3A
- Speed — 400RPM

## Installation Method



《 Vertical Bucket

Not included,  
sold separately.



《 Countertop  
Bucket



《 Embedded in  
countertop



# 07 **AUTOMATIC PORTAFILTER CLEANER**

## **Electrical Parameters and Important Safety Information**

Before using T1, please make sure to confirm and follow the following safety operation specifications.

- Read and understand all safety guidelines.
- Must use the standard power adapter.
- Please power off and unplug when not in use for a long time to extend the motherboard's lifespan.
- Do not expose the product to moisture or rain.
- Keep the product away from heat sources. Do not expose it to high temperatures, bake, or blow-dry.
- Do not let the product fall or be subjected to heavy impact, or apply heavy pressure to it.

### **1. Use safety**

- 1 . Keep the work area clean and bright, messy and dark areas can easily cause accidents.
- 2 . Do not operate T1 in explosive environments, such as flammable liquids, gases, or dust. The sparks generated may ignite dust or gas.
- 3 . When operating T1, please maintain a safe distance from bystanders.

### **2. Usage Scenarios**

- 1 . The device plug must match the socket, and the plug must not be modified in any way. Devices that require grounding must not use any adapter plugs. The original plug and matching socket will reduce the risk of electric shock.
- 2 . Avoid body contact with grounded surfaces, such as pipes, radiators, and refrigerators. If the body is grounded, it will increase the risk of electric shock.
- 3 . Do not expose T1 to rain.
- 4 . Do not misuse the cable. Never use the cable to carry, pull, or unplug the device. Damaged or tangled cables increase the risk of electric shock.
- 5 . When using T1 outdoors, please use an outdoor extension cord suitable for outdoor use, which will reduce the risk of electric shock.



# 08 AUTOMATIC PORTAFILTER CLEANER

## 3. Personal Safety

- 1 . Stay alert, pay attention to what you are doing, and stay awake when operating T1. Never operate T1 when tired, under the influence of drugs, alcohol, or medication.
- 2 . Avoid accidental startup. Ensure the switch is OFF before plugging in the device. Do not press the brush head with your hand when the device is powered on to avoid injury. Long press the switch until it turns red, indicating the device is off, before disassembling the brush head.
- 3 . Do not place your hands, knives, or other objects that may interfere with machine operation inside the unit while it is running. Wrenches or keys left on rotating parts of the brush head may cause injury.

## 4. Operation Briefings

- 1 . When replacing or disassembling the brush head, first unplug the power plug from the socket.
- 2 . Do not let chemicals such as acetone, benzene, thinner, ketones, trichloroethylene, etc. , come into contact with the T1 casing to avoid damage.
- 3 . Use T1 carefully. Do not drop or subject it to impact.

## 5. Use and Precautions

- 1 . Do not misuse T1. Use it appropriately according to its intended purpose.
- 2 . The main unit should not be washed or submerged in water. When cleaning, remove the inner container and cleaning head and rinse them with water.
- 3 . T1 If the switch cannot turn the device on or off, do not use T1
- 4 . Before making any adjustments, disassembling, cleaning, replacing accessories, or storing T1, unplug the power cord or disconnect the power adapter. This protective measure will reduce the risk of sudden startup of T1.
- 5 . Keep T1 out of reach of children when not in use, and do not let unfamiliar users operate the device.
- 6 . Check the installation deviation of moving parts, whether there is jamming, damaged parts, or other conditions that may affect the operation of T1.
- 7 . T1, accessories, and tool brush heads according to the requirements of the user manual, considering working conditions and the tasks being performed.



Warning:  
CHOKING HAZARD





## Siebträgerreiniger (eingebaut) – Öffnungshilfsdiagramm

(154 mm) Produktseite



(139 mm) Produktvorderseite



# INSTRUCTION MANUAL

## Contact Us

- 🌐 Website: [www.kaffee-klar.com](http://www.kaffee-klar.com)
- 🇪🇺 EU | REP: WANFU Trading GmbH
- 📍 Address: Guido Rütgers Str. 50/E2, 2201 Gerasdorf, Austria
- ✉ Email: [Office@kaffee-klar.com](mailto:Office@kaffee-klar.com)
- ⚙ Manufacturer: Chaozhou Yonghe Technoloy Co., Ltd
- 📍 Address: Caitang Town, Chaoan District, Chaozhou, Guangdong, China



[www.kaffee-klar.com](http://www.kaffee-klar.com)  
Product after-sales service

CE   
MADE IN CHINA